

El incumplimiento de estas instrucciones es de toda responsabilidad a TRES Grifería.
TRES Grifería declina toute responsabilité en cas d'insobserance de ces instructions.
Bei Nichtbefolgung der Bedienungsanleitung übernimmt TRES Grifería keinerlei Haftung.
Het niet opvolgen van deze instructies ontlast TRES Grifería van alle aansprakelijkheid.
L'iradempimento di queste istruzioni è onesta TRES Grifería da ogni responsabilità.
Nedodržení pokynů v návodu zbaňuje společnost TRES Grifería veškeré zodpovědnosti.
Any failure to follow these instructions releases TRES Grifería from any liability.
Niezastosowanie się do instrukcji zwalnia z wszelkiej odpowiedzialności TRES Grifería.

TRES

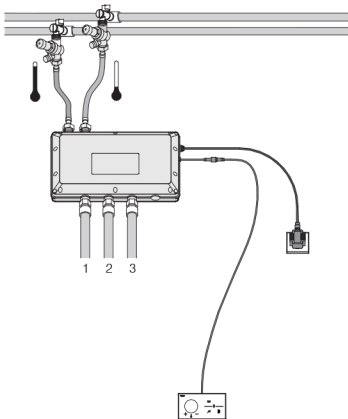

PURGAR INSTALACIÓN • PURGER L'INSTALLATION • WASSER AUS DEN ROHREN
ABLASSEN • DE INSTALLATIE ONTLUCHTEN • SPURGARE L'IMPIANTO • NECHTE Z
POTRUBÍ VYTĚČT VEŠKEROU VODU • BLEEDING THE EQUIPMENT • ODPROWADZIĆ
WODĘ Z INSTALACJI • PURGAR A INSTALAÇÃO • ПРΟΜΒΙΒΚΑ ΣΥΣΤΗΜΑ

INSTALACIÓN • INSTALLATION • INSTALLATION
• INSTALLATIE • INSTALLAZIONE INSTALACE •
INSTALLATION • MONTAŽ • INSTALAÇÃO • УСТАНОВКА

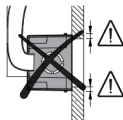
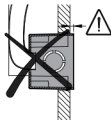
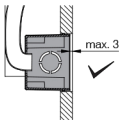
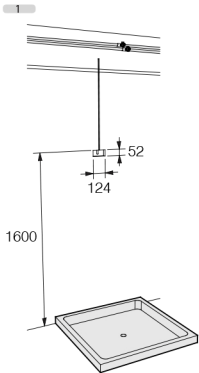
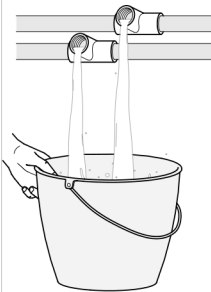

2

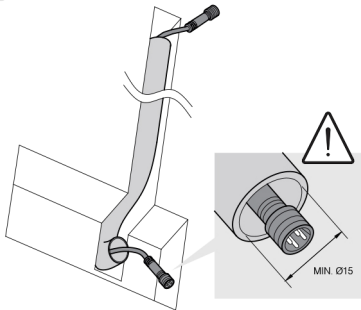

3

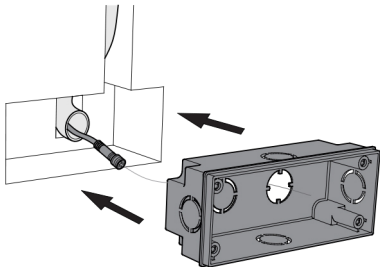

3

4

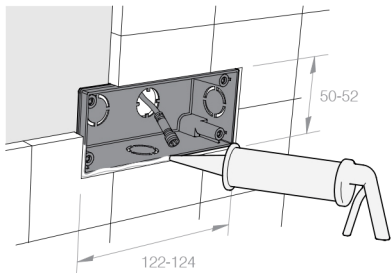

5

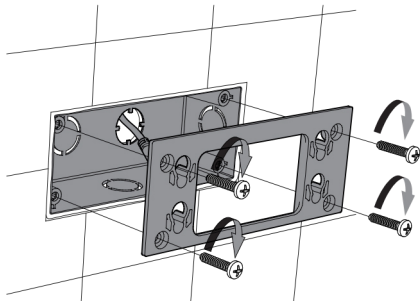

4

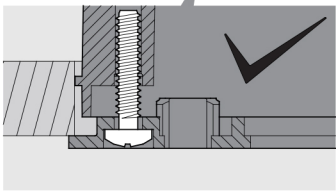
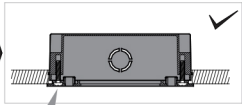
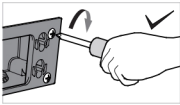
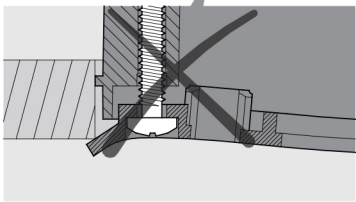
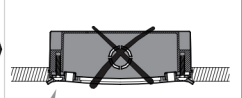

6

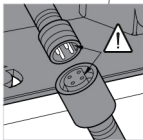
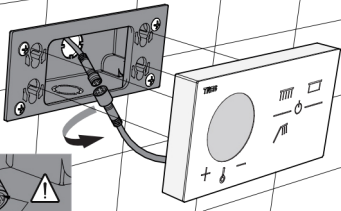

7

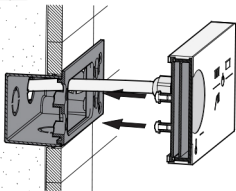

8

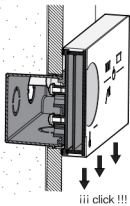

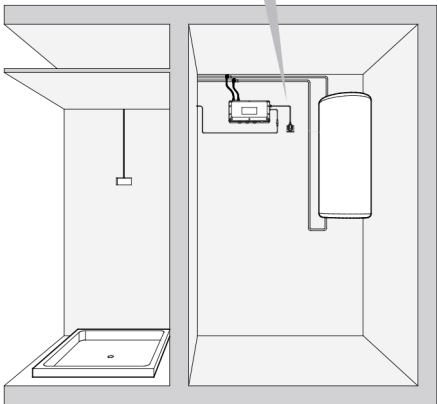

La ilustración de instalación es orientativa.
Colocar la caja de control en un lugar registrable y
de fácil acceso que permita realizar con facilidad las
tareas de mantenimiento.

*The installation picture is indicative.
Install the control box on a inspected and accessible
place, that allows an easy maintenance.*

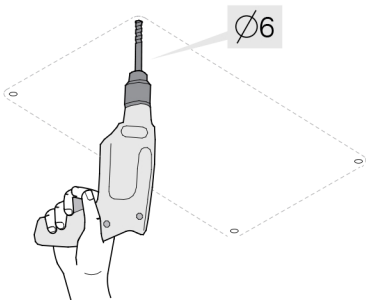
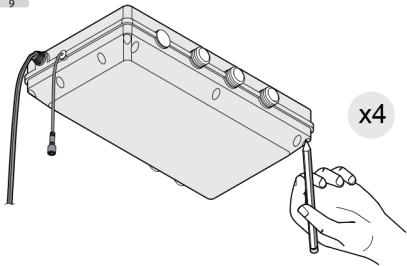

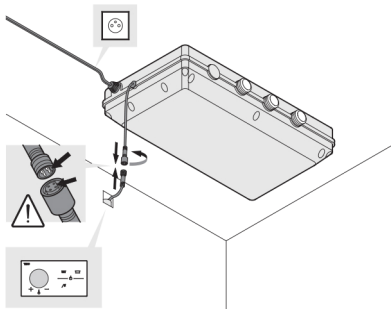
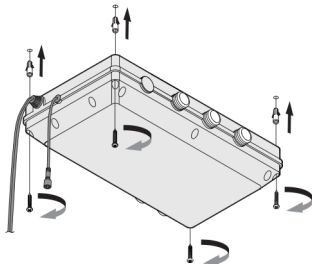

13

R.1/2'G. (x3)



No include
 Non fournis
 Nicht enthalten
 Niet meegeleverd
 Non fornite in dotazione
 Nejsou součástí dodávky
 Not included
 Nie załączone
 Não incluídas
 в комплект НЕ входит

R.1/2'G. (x2)



14

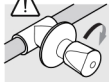

Filtro, Filtre,
 Filter, Filtr

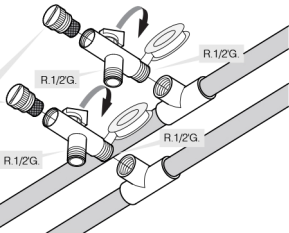

15

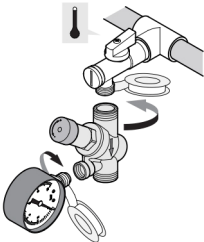

16

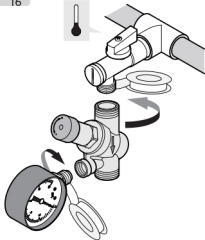

17

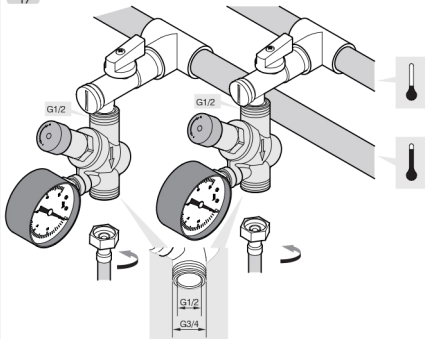

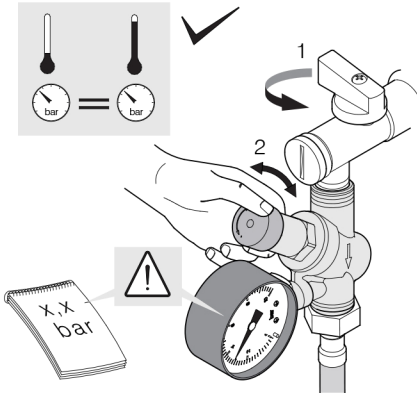

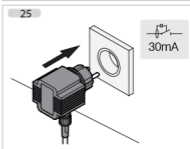
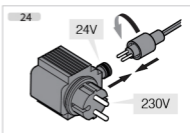
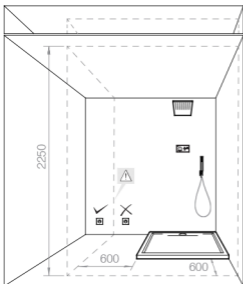
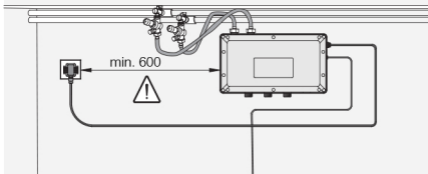



LIMPIEZA DE FILTROS • NETTOYAGE DES FILTRES • REINIGUNG DER FILTER
FILTERREINIGING • PULIZIA DEI FILTRI • ČIŠTĚNÍ FILTRŮ • CLEANING THE FILTERS
CZYSZCZENIE FILTRÓW • LIMPEZA DE FILTROS • ОЧИСТКА ФИЛЬТРОВ

1

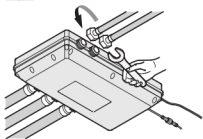

2

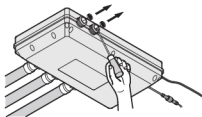

3



Filtro • Filtre • Filter • Filter • Filtri
Filty • Filter • Filtr • Filtro • Фильтр

1

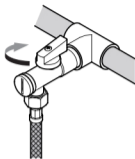

2

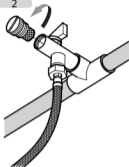

3



Es responsabilidad del usuario eliminar los residuos de este tipo depositándolos en un "punto limpio" para el reciclado de residuos eléctricos y electrónicos.

Il incombe à l'utilisateur d'éliminer les déchets de ce type en les déposant dans un « point propreté » destiné au recyclage des déchets électriques et électroniques.

Der Benutzer ist für ordnungsgemäße Entsorgung bzw. Wiederverwertung der anfallenden Abfälle verantwortlich.

Het is de verantwoordelijkheid van de gebruiker om dit soort afval te verwijderen en het bij een afvalverzamelpunt voor het recyclen van elektrisch en elektronisch afval te deponeren.

L'utente è responsabile dello smaltimento di questo genere di residui; dovrà depositarli presso un "punto di raccolta" per il riciclaggio di materiale elettrico ed elettronico.

Uživatel zodpovídá za likvidaci opotřebovaného výrobku nebo jeho součástí na sběrném místě určeném pro recyklaci odpadu z elektrických a elektronických zařízení.

The user is responsible for eliminating this type of waste, depositing them in a Recycling Centre for waste electrical and electronic equipment.

Użytkownik jest zobowiązany do usuwania tego rodzaju odpadów do odpowiedniego punktu recyklingu odpadów elektrycznych i elektronicznych.

É da responsabilidade do utilizador a eliminação deste tipo de resíduos, depositando-os num centro destinado à reciclagem de resíduos eléctricos e electrónicos.

пользователь несет ответственность за утилизацию отходов этого типа и обязан сдавать их в приемные пункты для дальнейшей переработки электрического и электронного оборудования.

